

oude kerk salon/big bang

EN

This summer, SALON/ presents 'Big Bang', an exhibition in collaboration with the Oude Kerk. Inspired by the idea that the universe originates from an act of creation, the works relate to ideas formed by human and nature such as: the big bang, belief, religion, superstition, rituals and devotion. SALON/ provides a platform where these ideas are questions are fought, rituals are performed and new stories - between creator and spectator, object and environment - emerge.

SALON/ is a platform for fashion, design, visual arts and related disciplines, giving designers and artists the opportunity to show their work in a different capacity and to disclose it to a diverse audience.

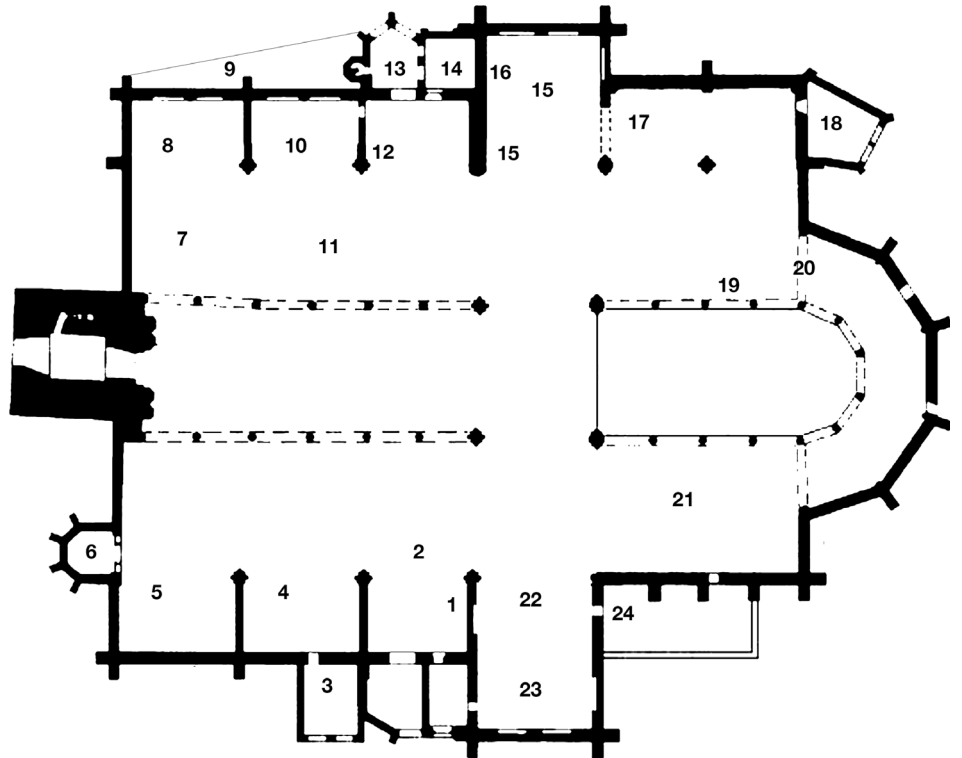

1 Margret Wibmer (1959, AT)

Absence of the teamaster is a time specific art event, based on the concept of the traditional Japanese tea ceremony and reinterpreted for the contemporary context. Through a collaborative process we exchange knowledge about Eastern and Western cultures. The different cultural concepts of space, relations and hierarchy, the body, nature, time, language, technology, art and the negotiation of differences, drives the artistic process and inspires the creation of new models for interaction.

2 Marc Bijl (1970, NL)

Broken 2012-19 October is an obelisk which represents in Bijl's version for the mathematical beauty of the unknown. The disruptive chaotic surface of broken mirrors and black epoxy stand for the life that lies behind you. It has, by chance, become a personal work: a tribute to the artist's father whose funeral took place on the day of the opening of Bijl's exhibition, hence the date in the title.

3 Conny Groenewegen (1973, NL)

Primary Explorers: 'With a Big Bang I was born and saw the light, immediate and irreversible. Everything that

came after seemed to be slow, slower, slowest compared to the urgency of that one first moment. That moment was decisive for what was to follow and it still leads me the way through abstractions as time and space as an internal compass. In *Primary Explorers I* show one black dress, a jumpsuit and a black smock with reflective trousers. The designs result of a few slow processes like knitting and seamlessly connecting the parts by hand before felting them. This way of working shows in the layering of the fabric and in the final compact shape of the garments. They seem to have absorbed time and will absorb the gaze if you give it time. Then it is about absolute light and darkness in the visual language of reflection and again absorption.'

4 MaryMe-JimmyPaul (2008)

Fashion label created by Marie Burlot and Jimmy Paul, working in the area between art and fashion. Taking inspiration from their own created stories, worlds, people and view on the current and past pop culture, they show fashion in a different way. Constantly pushing the boundaries of shape, textures and colours, they raise eyebrows with their big, sculptural works that not

only provide a surprising look, but also evoke a feeling.

5 Siba Sahabi (1979, NL)

Drawing from her German/Iranian roots, Siba's work aims to show how one culture can influence another, leading to renewal and cultural richness. A passion for crafts and imperfection drives the process of her work. Siba's new work entitled 'Qaina' (dance film) and 'Tarab' (sculptures) is a translation of dance into design.

6 Navid Nuur (1976, IR)

Nuur explores the properties and potentials of both materials and words, and our ability to perceive the reality. He reveals unexpected transformations and shifts by repositioning given functions and meanings. Nuur recontextualizes the everyday, giving his viewers a shifted experience of familiar objects and phenomena.

7 Joris Landman (1970, NL)

The image of a teapot floating in space comes from a 1950s article about religion, by thinker and scientist Bertrand Russell. In that text, Russell compared the belief in a god to the belief in a teapot orbiting the sun. Joris is fascinated by the Celestial Teapot.

Why and how are this imagery, and the ideas it represents, being perpetuated? Working from the assumption that the best way to understand how a thing works, is to actually make it, Joris aims to launch a teapot into space, following the literal words from the original article. He is bringing together a group of individuals and organizations to share this goal, and to turn the virtual icon into actual reality. The output of the project is an ongoing series of events, presentations and collaborations—with experts ranging from theologians to astrophysicists and ceramists, on subjects ranging from Christian liturgy to Silicon Valley and Alice in Wonderland—until that goal is realized.

8 rENs (NL)

One of the most conspicuous traditions and customs in the Zuiderzee region in The Netherlands was the characteristic costume in times of mourning. People who had lost a loved one wore regulation colours in shades varying from deep dark blue or black immediately after the death, to red when the mourning period was concluded. The moment when one could switch from one colour to the other was laid down in codes and regulations. Furthermore, the duration of the period of mourning was determined by the relationship that the bereaved had with the deceased. In this way everyone could see without being told in what stage the person in mourning was, as well as the seriousness of the lost. This was the central idea that the designers duo rENs used as a point of departure for a study that resulted in an unusual exhibition: *Mourning Materialized*. Here tapestries are displayed dyed according to traditional methods and manifesting both the different stages and the duration of the mourning costume. The tapestries, the length of which reflects people's life span. This represents a unique biography in colour and material.

9 Liselore Frowijn (1991, NL)

Liselore recently graduated cum laude at ArtEZ Institute of the Arts in Arnhem in 2013 on her bachelor of fashion design. In her work Frowijn is permanently searching for the clash on sportswear and luxury. The concept of her new collection *Fracture space* - presented at the exhibition- is based on the wardrobe of a woman who is fully at ease with herself. She moves elegantly and dynamically in space,

and lets no person interrupt her energy. Instinctively she knows the base of pure luxury.

10 Jef Montes (NL)

Montes graduated in 2012 from ArtEZ Institute of the Arts in Arnhem. He started his own label with the intention to bring his upcoming collections to a higher level and to develop his already unique style character. His studio is located in the centre of Arnhem, from which he experiments on his fascination for the manipulation of materials and architectural shapes. A combination from classical handicraft techniques which are transferred using innovative materials.

11 Germaine Kruip (1970, NL)

Acting is Like Sculpture takes its title from a quote by Orson Welles, which he followed with 'It's what you take away from yourself that reveals the truth of what you are doing.' Germaine Kruip, who worked in theatre before moving into visual arts, is fascinated with the process of transforming an object through a gesture. In analogy to Orson Welles' statement 'acting is like sculpture', Kruip's objects, like gestures, appear and disappear in movement.

12 Mimi Berlin (NL)

Mimi Berlin is a group of interdisciplinary creative people, based in Amsterdam. The installation *Evolutionary Extravaganza* offers a comprehensive explanation for a broad range of observed phenomena in animal species, e.g. the *Canis Collum Longus* (Doggie Longneck), born from the imagination of Mimi Berlin and created with the fascination for life in centuries gone by in mind. Mimi Berlin's member a-MB-iance, created the *Evolutionary Extravaganza* especially for Salon/Big Bang, it's an installation reminiscent of an ancient and worn down mini laboratory/museum, in which statuettes of imaginary animals and other life forms, designed by Mimi Berlin, are on show. All the statuettes are unique, signed pieces and are made with vintage-deluxe found objects.

13 Chris Kabel (1975, NL)

This Blue Sky Lamp by Chris Kabel produces light that is exactly the same as daylight on a sunny day. Special particles in the resin diffuse the LED light in the same way as the sunlight that enters the atmosphere. Hence the lamp is blue too, like the sky. The blue light can help in the case of winter

time depression.

14 Herman Verhagen (NL)

Five years ago Herman Verhagen decided to pause his work as a 3D-animation artist, and become a professional potter. He has been working on the wheel in his shop and studio in Central Amsterdam since 2011, making mostly dinnerware and vases. Since this summer he has retaken the production of works of a more artistic nature. Refinding the theme 'Disappearance', that Herman Verhagen was exploring in his animation-work, the installation GIB GNAB (June, 2014) shows a possible landscape of the future. Raised in the 80s in a Christian environment he was well aware of the possibilities of a nuclear end of the world. Where his animations were searching for a smooth solution in escaping existence, this time we see a more explosive materialisation that also shows the other end of the 'Big Bang' spectrum.

15 Karin Arink (1967, NL)

Karin Arink graduated in 1990 from the academy in Rotterdam, and was participant of the Rijksakademie from 1990-1992. She won the First Prize Prix de Rome Sculpture in 1992 and was nominated for a.o. the Illy Prize 2005. Her work is widely exhibited in group shows in the Netherlands and abroad. Since 1999 she is lecturer, coach and juror at various academies and since 2012 department coordinator in the Willem de Kooning academy Rotterdam.

16 Katja Mater (1979, NL)

Katja Mater's work originates from an interest in themes such as the experience of time in photography, the documentation of moments and situations with intangible characteristics, the exploration of the limits of human perception, and the specifications of the analogue medium of photography from a meta perspective. Mater's approach is much closer to drawing and painting and through a complex process that involves multiple negatives masks, she opposes the uniqueness of drawing to the multiplicity of her outcomes.

17 Manolis Tsipos (1979, GR)

State of Emergency is a video-work on memory and other perils: the Mariakapel is Oude Kerk's least affected spot by Amsterdam's Iconoclastic Fury of 1556 when Protestantism smashed the painted glass windows and broke-down the statues.

18 Marleen Elenbaas (1989, NL)

In her work Elenbaas explores the worth of everyday actions linked to fashion. Starting from tutorials, which are intended to transfer knowledge, she defines the added value of explaining an everyday action that is performed in a highly concentrated way. It is normal to do things mechanically or in a rush without attention for what you are actually doing. Daily actions are no longer considered important because they are a matter of course. Everything is designed to take over so there is room to be free and do important things.

19 Frank Bruggeman (1966, NL)

Answered prayers is an installation that refers to the ancient habit of votive offerings to saints or a divinity. Formerly lame persons deposited their crutches in churches and chapels as a testimony for the received help. The ship model hanging in the Oude Kerk is also a kind of votive offering, expressing the gratitude of ship owners and merchants for a safe and prosperous voyage. The title of the installation is taken from a remark by writer Truman Capote: "More tears are shed over answered prayers than unanswered ones."

20 Elke Baggen (1987, NL)

After finishing her Bachelor degree Industrial Design Engineering at the Technical University Delft, Baggen studied at the Rietveld Academie in Amsterdam. In 2012 she graduated from the Image & Language department with the installation *A rigid nature and its animated representation*, presented in the exhibition. Her work has been exhibited at KunstKamers Rotterdam, W139 and the Stedelijk Museum Amsterdam.

21 Klaas Kuiken (NL)

Upload your portrait to www.beingjesus.nl with your smartphone and within 5 seconds your face will be visible on the styrofoam sculpture of Jesus. This interactive project 'Being Jesus' is by Klaas Kuiken, productdesigner) and Peter van der West, interactive designer).

22 MAISON the FAUX

The label MAISON the FAUX aspires to be an affectionate reaction to the current fashion industry and a big faux wink in the direction of an audience. Creating 'human wear', MAISON the FAUX aims to speak to an audience who feels liberated enough to move

freely, through a world which constantly forces us to think narrow mindedly.

23 Martin Butler (GB) & Floris Didden (NL)

In a Landscape (digital print on wood, 2014) is a collaboration project between artist and stage director Martin Butler and digital painter Floris Didden. Inspired by early 19th century theatre design, Floris created a three dimensional digital painting allowing you to enter into a fairy realm. Using the classical stage principles of 'trompe-l'œil', and forced perspective, the viewer is able to peer into and enter this representation of a world between worlds.

24 Desiree Hammen (NL)

A plant a tree and me (2014). Plants communicate with people, plants react to music, and plants have feelings. This is the essence of *The Secret Life of Plants*, a book by Peter Tompkins and Christopher Bird, published in 1973. In the end, humans and plants are closely related, so it's not strange that they 'communicate' to each other. Humans seem to be prevailing in this peculiar relationship. But if you are standing in the jungle, between these giant plants, which you also have in your living room in a 50 cm version, you feel super-tiny. You feel flabbergasted by the power, the charisma and the eternity they carry within them.

Salon/big bang is on view from June 27 until August 24, 2014

More information:
oudekerk.nl
salon1.org